

Sechskantmuttern Kl. 8

DIN 934 DIN-EN 4032

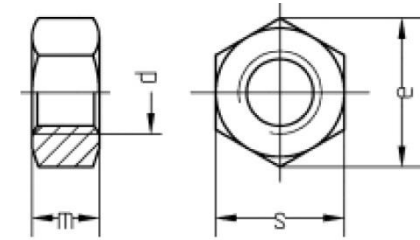

d	M 3	M 4	M 5	M 6	M 8	M 10	M 12	M 14	M 16	M 18	M 20	M 24	M 30
m	2,4	3,2	4	5	6,5	8	10	11	13	15	16	19	24
e	6,01	7,66	8,79	11,05	14,38	18,90	21,10	24,49	26,75	29,56	32,95	39,55	50,85
s	5,5	7	8	10	13	17	19	22	24	27	30	36	46